

Technical features of VDI tool holders

The VDI tool holders for CNC lathes are made of hardened steel with a resistance of about 900 N / mm², a hardness of 56 ± 2 HRC and a depth of hardening of at least 0.5 mm.

All VDI tool holders have a cylindrical shaft with h6 tolerance, **internal coolant supply and nozzles with adjustable ball groove**. The shaft and the contact surface are tempered and rectified, with coolant supply hole.



VDI A1 square tool holder

DIN 69880

VDI tool holder A1 square shape, untreated body, without registration

Application: to create special versions.

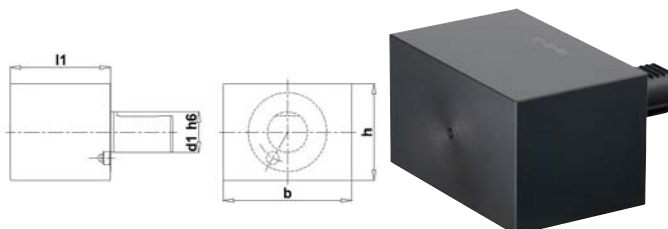

Code	€	VDI	l1 (mm)	b (mm)	h (mm)
C352690001	---	30	85	130	76
C352690004	---	40	100	151	96

Code	€	VDI	l1 (mm)	b (mm)	h (mm)
C352690007	---	50	125	160	120



VDI A2 cylindric tool holder

DIN 69880

VDI tool holder A2 cylindrical shape, untreated body, without registration.

Application: to create special versions.

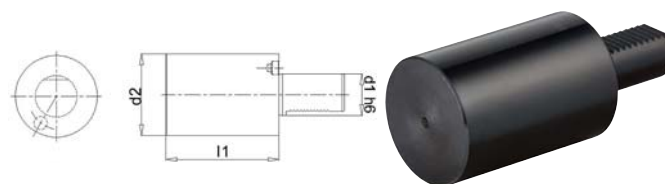

Code	€	VDI	d2 (mm)	l1 (mm)
C352720001	---	30	68	100
C352720004	---	30	68	240
C352720007	---	40	83	120

Code	€	VDI	d2 (mm)	l1 (mm)
C352720010	---	40	83	320
C352720013	---	50	98	135
C352720016	---	50	98	400



VDI AR tool holder for cutting blades

VDI toolholder AR shape **version right**, with external coolant supply.

Application: for mounting cutting blades.

DIN 69880

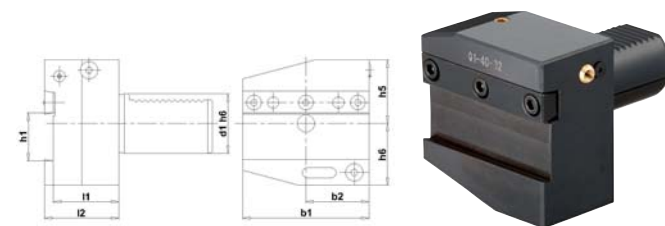

Code	€	VDI	h1 (mm)	b1 (mm)	b2 (mm)	h5 (mm)	h6 (mm)	l1 (mm)	l2 (mm)
C352730001	---	30	26	70	35	32	39	44	50
C352730004	---	40	26	85	42,5	43	41,5	44	50

Code	€	VDI	h1 (mm)	b1 (mm)	b2 (mm)	h5 (mm)	h6 (mm)	l1 (mm)	l2 (mm)
C352730007	---	40	32	85	42,5	43	41,5	44	50
C352730010	---	50	32	100	50	43	45	44	50



VDI AL tool holder for cutting blades

VDI toolholder AL shape **version left**, with external coolant supply.

Application: for mounting cutting blades.

DIN 69880

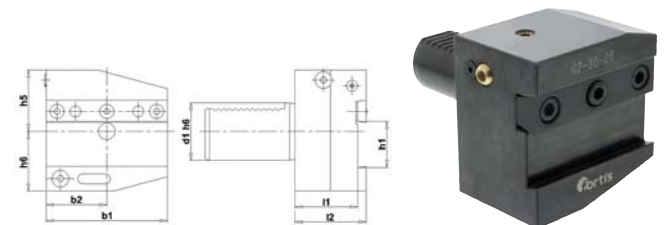

Code	€	VDI	h1 (mm)	b1 (mm)	b2 (mm)	h5 (mm)	h6 (mm)	l1 (mm)	l2 (mm)
C352810001	---	30	26	70	35	32	39	44	50
C352810004	---	40	26	85	42,5	43	41,5	44	50

Code	€	VDI	h1 (mm)	b1 (mm)	b2 (mm)	h5 (mm)	h6 (mm)	l1 (mm)	l2 (mm)
C352810007	---	40	32	85	42,5	43	41,5	44	50
C352810010	---	50	32	100	50	43	45	44	50