

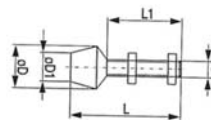

Pressure screw

Pressure screw with two fixing nuts, vulcanised neoprene, resin-free (85°Shore), thermal treated, galvanized and passivated, temperature resistant -20° to +80°.



Code	€	G (M)	ø D (mm)	L (mm)	L1 (mm)	ø D1 (mm)
C603650005	◆	6	16	44	30	12
C603650010	◆	6	16	54	40	12
C603650015	◆	8	21	53	35	14

Code	€	G (M)	ø D (mm)	L (mm)	L1 (mm)	ø D1 (mm)
C603650020	◆	8	21	63	45	14
C603650025	◆	10	26	79	55	20
C603650030	◆	12	30	102	73	24



Pressure screw

Pressure screw with 2 hex nut, thermal treated, galvanized and passivated.

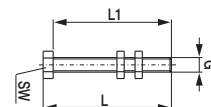

Code	€	G (M)	L (mm)	L1 (mm)	SW (mm)
C603570105	◆	6	49	45	10
C603570110	◆	8	75,5	70	13
C603570115	◆	10	77	70	16

Code	€	G (M)	L (mm)	L1 (mm)	SW (mm)
C603570120	◆	12	88	80	18
C603570125	◆	16	130	120	24



Fixing bracket

Galvanized and passivated fixing bracket.



Model 1

Model 2

Model 3

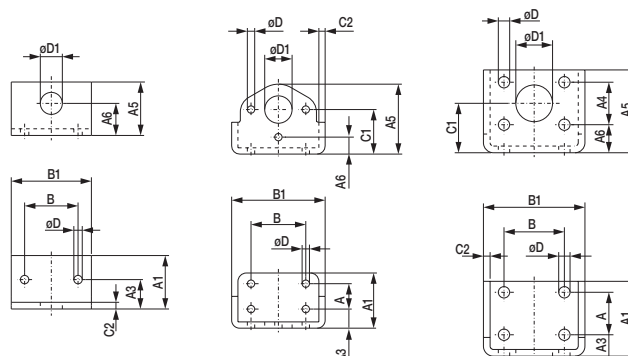

Model 1

Model 2

Model 3

Code	€	Execution	A (mm)	A1 (mm)	A3 (mm)	A4 (mm)	A5 (mm)	A6 (mm)	B (mm)	B1 (mm)	C1 (mm)	C2 (mm)	øD (mm)	øD1 (mm)
C603580005	◆	model 1	-	39,9	22,1	-	39,9	24	39,9	59,9	-	5,1	6,6	16,5
C603580010	◆	model 2	19,1	40,6	14,5	-	52,6	12,4	41,1	71,1	33	4,6	5,6	19,1
C603580015	◆	model 3	32	55,9	16	32	62	21,1	45	76,2	37,1	5,1	8,4	27,4



Permanent magnet in alnico alloy

Permanent magnet in alnico alloy, screened with brass ring, the shielding ensures a greater Magnetic coercivity, to allow them to maintain their features unchanged even if in contact with ferrous components, external impact protection, resistance to heat up to 450°.

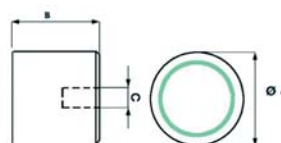

Code	€	Pz	ø A (mm)	B (mm)	C	Retaining force (Kg)
C606055005	◆	1	9,5	15	M3	1,5
C606050127	◆	10	12,7	15,8	M4	2
C606050175	◆	5	17,5	15,8	M6	4
C606050206	◆	5	20,6	19	M6	5,5
C606050270	◆	5	27	25,4	M6	10

Code	€	Pz	ø A (mm)	B (mm)	C	Retaining force (Kg)
C606050350	◆	5	35	20	M6	12
C606050351	◆	5	35	30	M6	18
C606050450	◆	2	45	30	M8	40
C606050500	◆	2	50	40	M8	50
C606050550	◆	2	55*	14	M8	10

*Ceramic magnet, heat-resistant up to 150 °C.